

Single Row Ball Bearing Turntables

Single row ball bearing turntables are for trailers and agricultural vehicles, connecting the A-frame to the trailer chassis. The turntable allows the axle to turn relative to the trailer frame transferring both the axial, and radial forces. The lower (outer) ring is bolted to the A-frame and the upper ring (inner) ring is bolted to the chassis.



Double Row Ball Bearing Turntables

Double row ball turntables guarantee optimum distribution of the axial and radial forces. This design has proven through years of different applications. Double row ball turntables are used in particular when the vehicle application requires both precision and strength in design and material.



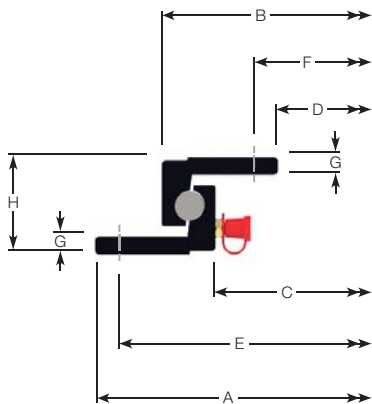

L and N Style Turntables

Application:

L Series: Farm vehicles and trailers up to 15 mph.

N Series: Farm vehicles and trailers over 15 mph.

All load data for L and N series applies to use on paved roads in steering systems.

Specifications: Standard Lubrication, Undrilled

Type	A	B	C	D	E	F	G	H	Weight (lbs)	Axial Load Ton (Short)
400L	15 3/4"	13 7/16"	11 1/2"	9 1/16"	14 3/4"	10 1/4"	5/16"	1 3/4"	23	0.84
500L	19 11/16"	17 3/8"	15 7/16"	13"	18 11/16"	14 3/16"	5/16"	1 3/4"	31	1.01
650L	25 9/16"	23 5/16"	21 5/16"	18 7/8"	24 5/8"	20 1/16"	5/16"	1 3/4"	41	1.69
750L	29 1/2"	27 1/4"	25 1/4"	22 13/16"	28 9/16"	24"	5/16"	1 3/4"	47	2.02
850L	33 7/16"	31 3/16"	29 3/16"	26 3/4"	32 1/2"	27 15/16"	5/16"	1 3/4"	55	2.81
500N	19 11/16"	17 3/16"	15 1/8"	12 3/8"	18 11/16"	13 3/8"	5/16"	2 1/16"	47	2.02
650N	25 9/16"	23 1/8"	21"	18 5/16"	24 5/8"	19 5/16"	5/16"	2 1/16"	57	2.81
750N	29 1/2"	27 1/16"	24 15/16"	22 1/4"	28 9/16"	23 1/4"	5/16"	2 1/16"	65	3.37
850N	33 7/16"	31"	28 7/8"	26 3/16"	32 1/2"	27 3/16"	5/16"	2 1/16"	74	3.93
950N	37 3/8"	34 15/16"	32 13/16"	30 1/8"	36 7/16"	31 1/8"	5/16"	2 1/16"	82	4.5

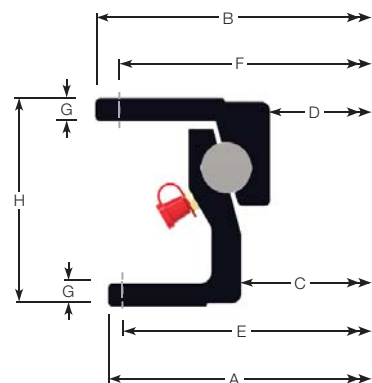

HE Style Turntables

Application:

The specified axle load relates to use where the turntable is mounted on the front axle of a trailer with three axles travelling at speeds of up to 65 mph.

On dual-axle trailers, the specified axle loads can be exceeded by 10% (20% at speeds below 18 mph).

Specifications: Standard Lubrication, Drilled, Primed

Type	A	B	C	D	E	F	G	H	Weight (lbs)	Axial Load Ton (Short)
HE1000-22	39 3/8"	39 13/16"	34 7/8"	33 15/16"	37 13/16"	38 3/8"	3/8"	3 9/16"	138	11.24

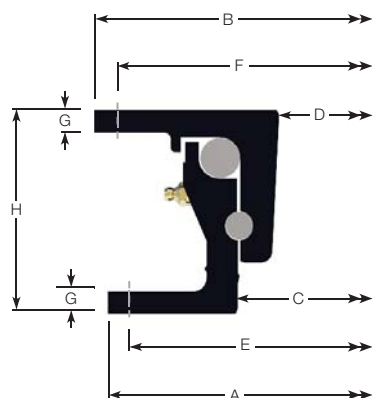

DK Style Turntables

Application:

The specified axial load applies to vehicles travelling up to 65 mph. A 25% higher axial load is permitted for vehicles with speeds below 18 mph. Please contact JOST if the application will have off-center loads or in applications where there is more than a 360 rotation.

Specifications: Standard Lubrication, Drilled, Primed

Type	A	B	C	D	E	F	G	H	Weight (lbs)	Axial Load Ton (Short)
DK 90/12	38 7/8"	39 3/8"	34 5/16"	32 13/16"	37 1/2"	38 1/16"	3/8"	3 9/16"	158	13.22
DK 90/16	43 1/8"	43 5/8"	38 9/16"	37 1/8"	41 3/4"	42 5/16"	3/8"	3 9/16"	180	17.63